

linked option "V"
1/2" thread, no valve.

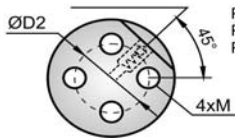

PNGH-1,5
PNGH-3,0
PNGH-5,0

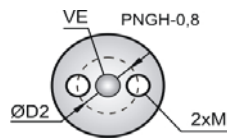

PNGH-0,8

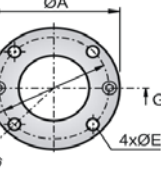
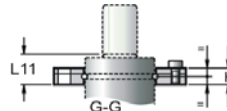

PNB-04-xxx

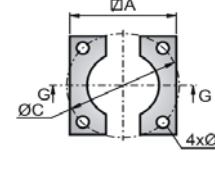
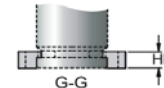

PNB-05-xxx

Type **PNGH** - tonnage **X,X** - stroke **XXX** / serie **XX X** Linked option

RNGH - **X,X** / **XX**

Repair kit

Semi compact self contained

	models	PNGH-0,8-	PNGH-1,5-	PNGH-3,0-	PNGH-5,0-
	constant k=>		70	102	102
height=>		L	L	L	L
PNGH-x,x-	-007				
	-010	90	122		
	-015	100	132	132	132
	-020	110	142	142	142
	-025	120	152	152	152
	-032	134	166	166	166
	-038	146	178	178	178
	-050	170	202	202	202
	-063	196	228	228	228
	-080	230	262	262	262
	-100	270	302	302	302
	-125	320	352	352	352
	-160		422	422	422
	-200			502	502
-250				602	
refer.		PNGH-0,8-	PNGH-1,5-	PNGH-3,0-	PNGH-5,0-
cil.: Initial force in daN at 130bar	F.in.	625	1.226	2.502	4.228
Initial force in daN at 150 bar	F.in.	722	1.414	2.886	4.878
area (cm ²)	área	4,91	9,62	19,63	33,18
diameter of the rod	Ød	25	35	50	65
diameter of the body	ØD	50	75	95	120
	L1		3		
	L6	14,5	18	21	22,5
	R	2		2,5	
cil. Base:	valve	Ve	bottom port G 1/8" thread	lateral port 1/2" thread	
	linked default	lpd	not available	lateral port 1/2" thread, no valve	
	linked option "V"	lop		bottom port 1/2" thread, "V"	
	holes	M	2 x M8 x 13	4 x M8 x 13	
	diameter drilling	ØD2	26	40	60
				80	
flanges:	round flange superior	-04-	PNB-04-008	PNB-04-015	PNB-04-030
	split flange inferior	-05-	PNB-05-008	PNB-05-015	PNB-05-030
	round external diameter	ØA	95	122	150
	split external dimension	ØA	75	100	120
	diameter drilling	ØC	80	104	130
	diameter of the holes	ØE	9	11	13
	height	H	13	16	18
	split height	Hb		12	
	part inferior to the top of the stem	L11	24	29	33
					36

The PRODTY is holder of Brazilian and international patents, that collect characteristics of their drawings.