

PNLH-0,8
PNLH-1,5
PNLH-3,0
PNLH-5,0

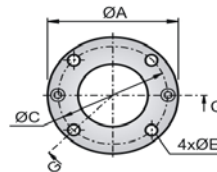

PNB-04-xxx

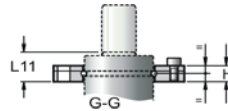
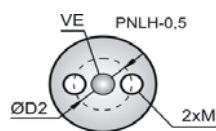
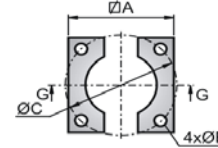
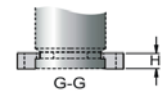

PNB-05-xxx

Type **PNLH** - tonnage **X,X** - stroke **XXX** / serie **XX X** Linked option

Type **RNLH** - tonnage **X,X** / serie **XX**

Repair Kit

Self contained with round base and less increased pressure.

| models | | PNLH-0,5- | PNLH-0,8- | PNLH-1,5- | PNLH-3,0- | PNLH-5,0- | | |
|----------------------|--------------------------------------|-----------|------------------------------|------------------------------------|--------------|-----------------------|-----|-----|
| (L = k + 2 x Stroke) | constant k=> | 85 | 95 | 110 | 120 | 140 | | |
| | height=> | L | L | L | L | L | | |
| | Stroke | -007 | | | | | | |
| | | -010 | 105 | 115 | | | | |
| | | -015 | 115 | 125 | 140 | 150 | 170 | |
| | | -020 | 125 | 135 | 150 | 160 | 180 | |
| | | -025 | 135 | 145 | 160 | 170 | 190 | |
| | | -032 | 149 | 159 | 174 | 184 | 204 | |
| | | -038 | 161 | 171 | 186 | 196 | 216 | |
| | | PNLH-x,x- | -050 | 185 | 195 | 210 | 220 | 240 |
| | | | -063 | 211 | 221 | 236 | 246 | 266 |
| | | | -080 | 245 | 255 | 270 | 280 | 300 |
| | -100 | | 285 | 295 | 310 | 320 | 340 | |
| | -125 | | 335 | 345 | 360 | 370 | 390 | |
| | | -160 | | 415 | 430 | 440 | 460 | |
| | -200 | | | 510 | 520 | 540 | | |
| | -250 | | | | 620 | 640 | | |
| | refer. | PNLH-0,5- | PNLH-0,8- | PNLH-1,5- | PNLH-3,0- | PNLH-5,0- | | |
| cil.: | Initial force in daN at 130bar | F.in. 400 | 625 | 1.226 | 2.502 | 4.228 | | |
| | Initial force in daN at 150 bar | F.in. 462 | 722 | 1.414 | 2.886 | 4.878 | | |
| | area (cm ²) | ârea 3,14 | 4,91 | 9,62 | 19,63 | 33,18 | | |
| | diameter of the rod | Ød 20 | 25 | 35 | 50 | 65 | | |
| | diameter of the body | ØD 50 | 75 | 95 | 120 | 150 | | |
| | L1 | 2 | | | 3 | | | |
| | L6 | 14,5 | 18 | 21 | 22,5 | 24,5 | | |
| | R | 2 | | | 2,5 | | | |
| cil. Base: | valve | Ve | bottom port G 1/8" thread | lateral port 1/2" thread | | | | |
| | linked default | ∅ lpd | not available | lateral port 1/2" thread, no valve | | | | |
| | linked option "V" | ∅ lop | bottom port 1/2" thread, "V" | | | | | |
| | holes | M | 2 x M8 x 13 | 4 x M8 x 13 | 4 x M10 x 16 | | | |
| | diameter drilling | ØD2 | 26 | 40 | 60 | 80 100 | | |
| flanges: | round flange superior | -04- | PNB-04-008 | PNB-04-015 | PNB-04-030 | PNB-04-050 PNB-04-075 | | |
| | split flange inferior | -05- | PNB-05-008 | PNB-05-015 | PNB-05-030 | PNB-05-050 PNB-05-075 | | |
| | round external diameter | ØA | 95 | 122 | 150 | 175 220 | | |
| | split external dimension | ∅ A | 75 | 100 | 120 | 140 190 | | |
| | diameter drilling | ØC | 80 | 104 | 130 | 155 195 | | |
| | diameter of the holes | ØE | 9 | 11 | | 13 18 | | |
| | height | H | 13 | 16 | 18 | 21 27 | | |
| | split height | Hb | 12 | | | | | |
| | part inferior to the top of the stem | L11 | 23 | 29 | 33 | 36 41 | | |

The PRODTY is holder of Brazilian and international patents, that collect characteristics of their drawings.